

V-Return Idlers

Manages Rugged Loads While Aligning Long Overland Belts

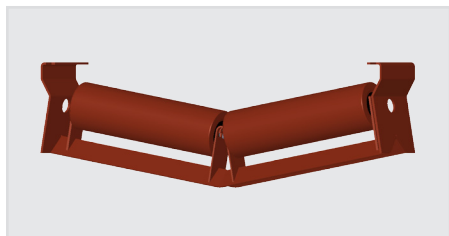

Quick Specs

- ▶ Classes: CEMA C, D, and E
- ▶ Roll Diameters: 5", 6", and 7"
- ▶ Belt Widths: 36" - 96"

Frequently Asked Questions

What are common applications?

- ▶ Primarily used on long overland conveyors, v-return idlers are used in applications with wide, thick and heavy belting or horizontal curve conveyors.

What is the load rating?

- ▶ There are factors that we need to consider before recommending a load rating (i.e. belt weight, idler spacing, feet-per-minute). However, it is safe to say that v-return idlers have better or stronger load ratings than standard one roll returns.

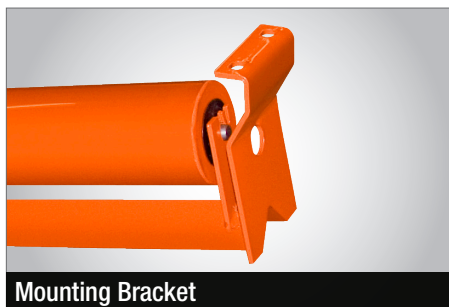

Features and Benefits

Save the Belt

- ▶ Help keep the belt aligned
- ▶ Two-roll returns have higher load ratings than single rolls

Easy Installation

- ▶ Easy mounting into standard return roll locations
- ▶ Avoid making changes to conveyor structure

SpinGuard® Seal Technology

- ▶ Contact seal helps prevent foreign material from entering seal cavity
- ▶ Grease-filled triple labyrinth seal shuts out contaminants
- ▶ Stationary external seal prevents material pinch points

Part Number Guide

Example: C5-10RETV-36

